

PRODUCT INFORMATION

08-2025

GRIP

SLEEPING

WARDROBE WITH SLIDING DOORS 2-PART

carcase modules
 W: 40 / 50 / 60 / 70 / 80 / 100 / 120
 H: 195 / 214 / 233 / 243 / 253 / 272
 total depth incl. front: 66.2 / 70.1
 Effective depth: Shelf 54.0 / Clothes bar 61.4

Possible cabinet widths
 W: 160 / 180 / 200 / 240 / 280 / 300 / 320 / 360 / 400

Dimensions in cm

EXAMPLE COMPOSITION TOTAL WIDTH 320 CM - 2 SLIDING DOORS

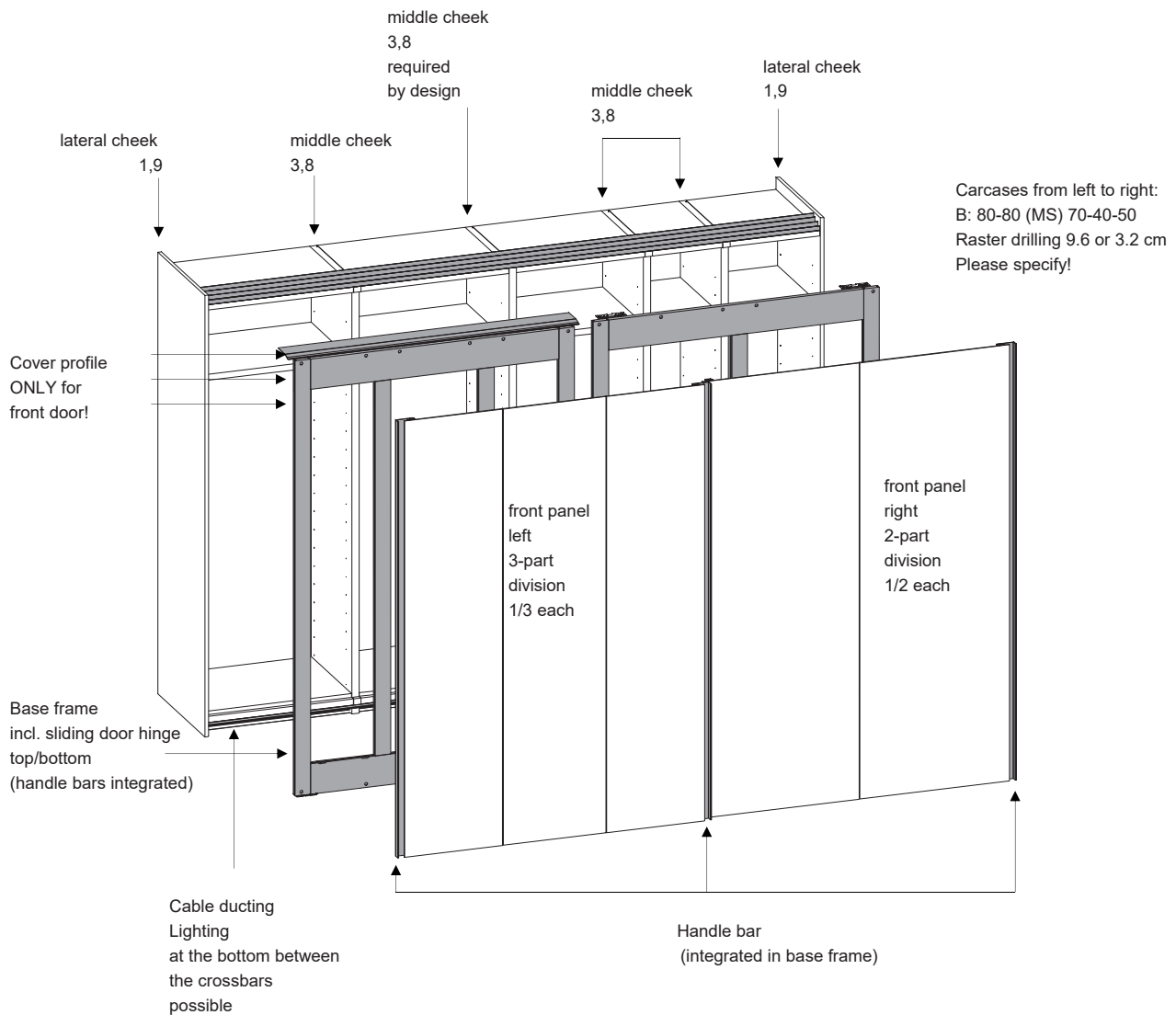

BASE FRAME 2 rails TOP VIEW - WITH 2 SLIDING ELEMENTS



PLANNING INFORMATION:

- required height for installation +4.0 cm
- required width for installation: +4.0 cm
- lining left/right possible; not possible at top!
- Wall mounting (anti-tilt) backside left and right through rear wall required. Fitting included.
- room divider not possible!
- Shortening in T/H possible! See special requests.

WARDROBE WITH SLIDING DOORS 3-PART

carcase modules
 W: 40 / 50 / 60 / 70 / 80 / 100 / 120
 H: 195 / 214 / 233 / 243 / 253 / 272
 total depth incl. front: 66.2 / 70.1
 Effective depth: Shelf 54.0 / Clothes bar 61.4

Possible cabinet widths
 W: 160 / 180 / 200 / 240 / 280 / 300 / 320 / 360 / 400
 Dimensions in cm

EXAMPLE COMPOSITION TOTAL WIDTH 360 CM - 3 SLIDING DOORS

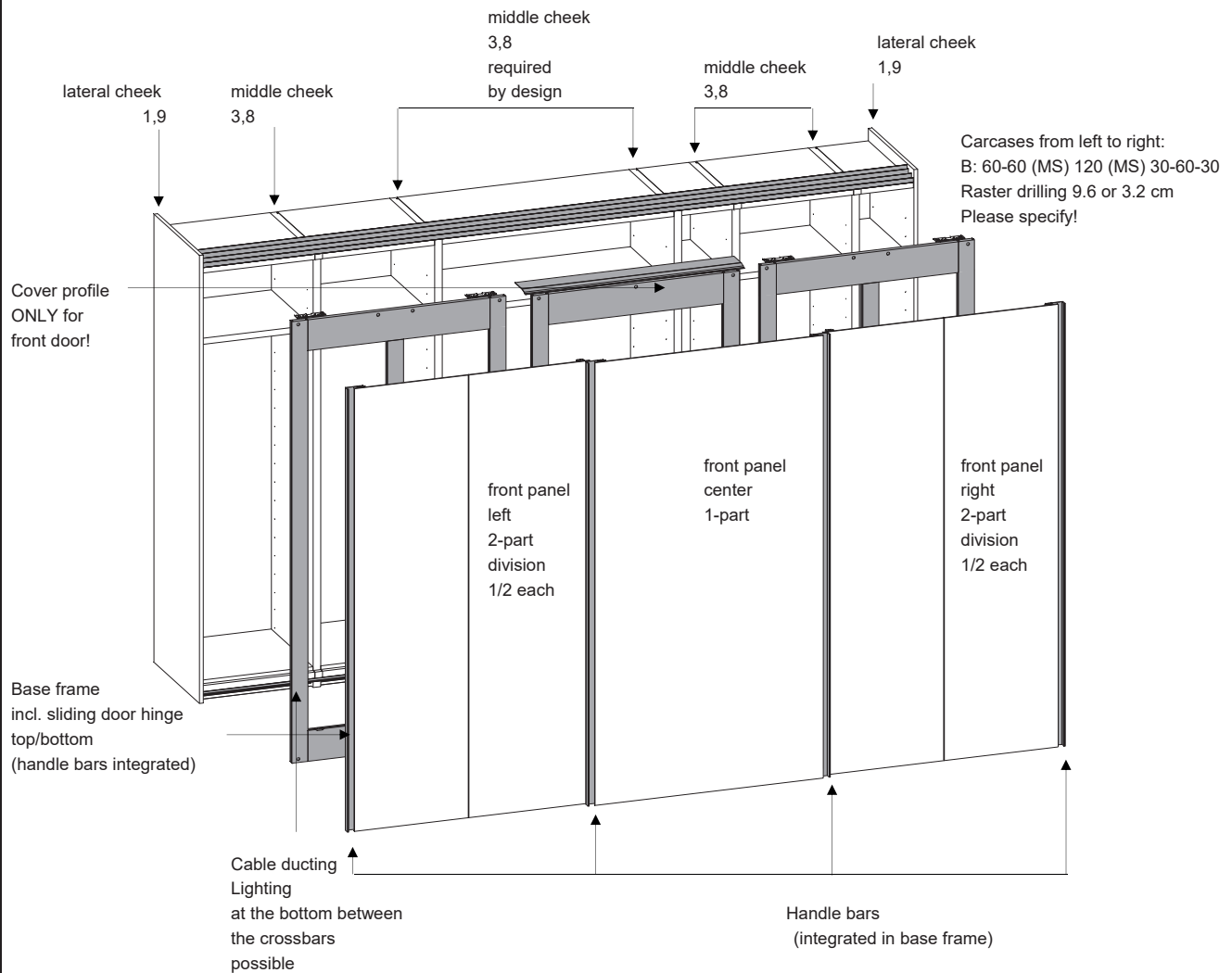

BASE FRAME 2-part TOP VIEW - WITH 3 SLIDING DOORS

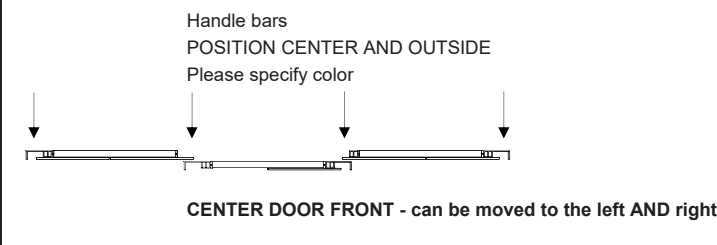

PLANNING INFORMATION:

- required height for installation +4.0 cm
- required width for installation: +4.0 cm
- lining left/right possible; not possible at top!
- Wall mounting (anti-tilt) backside left and right through rear wall required. Fitting included.
- room divider not possible!
- Shortening in T/H possible! See special requests.

| FRONT PANEL ARRANGEMENT Dimensions in cm | BASE FRAME | | | FRONT PANELS | | | | | |
|---|-------------------------|----------------------|-----------------------|--------------|---------|---------|--------|---------|---------|
| | Wardrobe Total width | left sliding door | right sliding door | LEFT | | | RIGHT | | |
| | | | | 1-PART | 2-PARTS | 3-PARTS | 1-PART | 2-PARTS | 3-PARTS |

BASE FRAME
incl. sliding door fittings

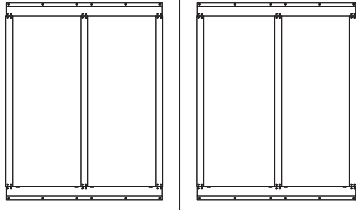

| | | | | | | | | | |
|-----|-----|-----|--|--|--|--|--|--|--|
| 160 | 80 | 80 | | | | | | | |
| 180 | 90 | 90 | | | | | | | |
| 200 | 100 | 100 | | | | | | | |
| 240 | 120 | 120 | | | | | | | |
| 280 | 140 | 140 | | | | | | | |
| 300 | 150 | 150 | | | | | | | |
| 320 | 160 | 160 | | | | | | | |
| 360 | 180 | 180 | | | | | | | |
| 400 | 200 | 200 | | | | | | | |

1-PART

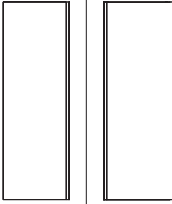

| | | | | | | | | | |
|-----|-----|-----|--|-----|--|--|-----|--|--|
| 160 | 80 | 80 | | 80 | | | 80 | | |
| 180 | 90 | 90 | | 90 | | | 90 | | |
| 200 | 100 | 100 | | 100 | | | 100 | | |
| 240 | 120 | 120 | | 120 | | | 120 | | |

2-PARTS

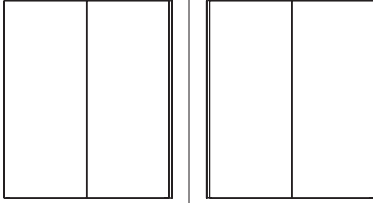

| | | | | | | | | | |
|-----|-----|-----|--|--|--------|--|--|--------|--|
| 200 | 100 | 100 | | | 2x 50 | | | 2x 50 | |
| 240 | 120 | 120 | | | 2x 60 | | | 2x 60 | |
| 280 | 140 | 140 | | | 2x 70 | | | 2x 70 | |
| 300 | 150 | 150 | | | 2x 75 | | | 2x 75 | |
| 320 | 160 | 160 | | | 2x 80 | | | 2x 80 | |
| 360 | 180 | 180 | | | 2x 90 | | | 2x 90 | |
| 400 | 200 | 200 | | | 2x 100 | | | 2x 100 | |

3-PARTS

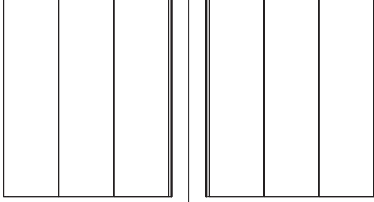

| | | | | | | | | | |
|-----|-----|-----|--|--|--|--------|--|--|--------|
| 300 | 150 | 150 | | | | 3x 50 | | | 3x 50 |
| 320 | 160 | 160 | | | | 3x 60* | | | 3x 60* |
| 360 | 180 | 180 | | | | 3x 60 | | | 3x 60 |
| 400 | 200 | 200 | | | | 3x 70* | | | 3x 70* |

PLANNING INFORMATION:
 - Front panels 3-parts in widths 320 and 400:
 * Front panels in the next larger width dimension are required. These are shortened accordingly.

INTERIOR FOR WARDROBE

W: 40 / 50 / 60 / 70 / 75 / 80 / 90 / 100 / 120

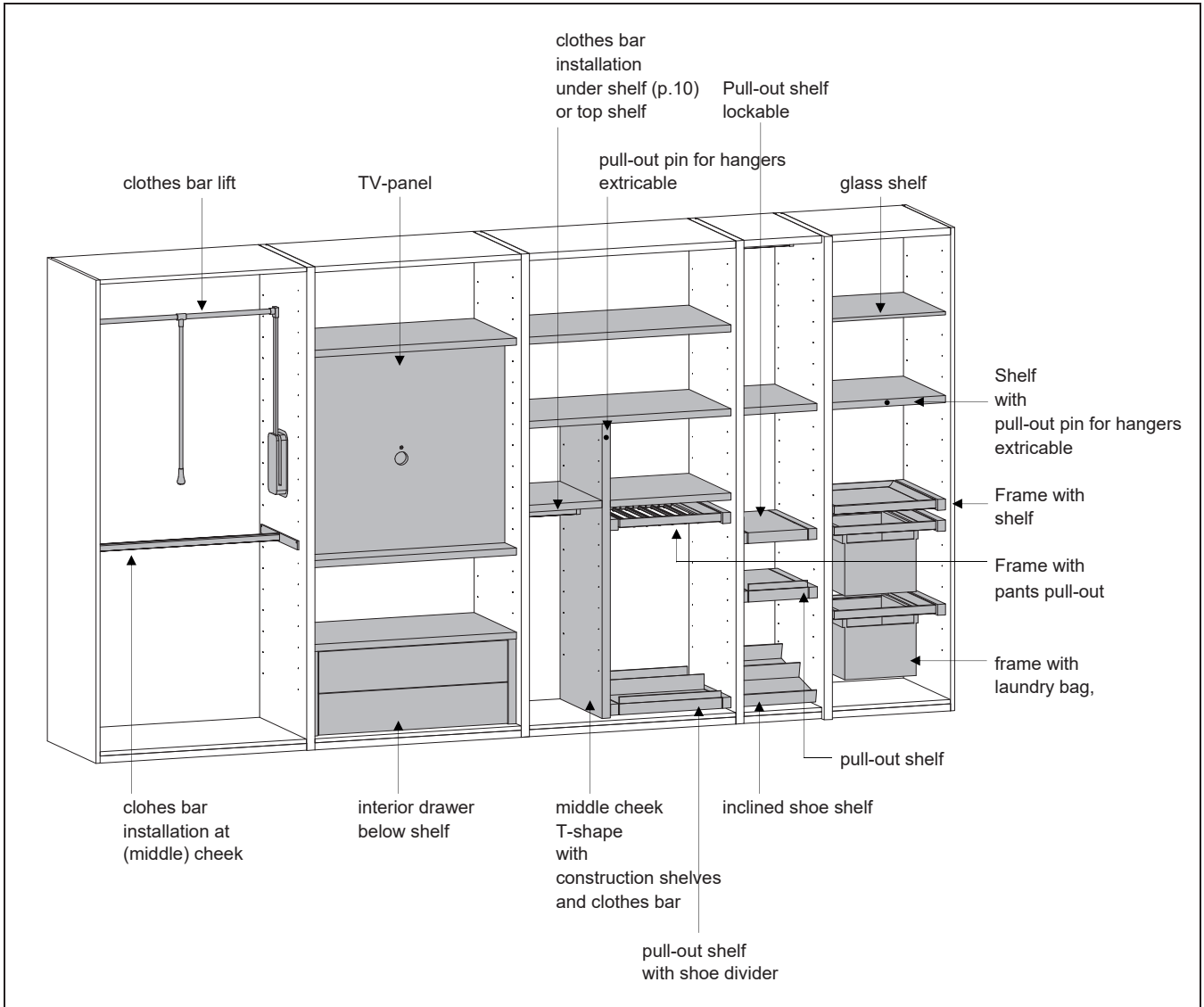

PLANNING INFORMATION:

- Interior partitions in widths 75 and 90 ONLY for FLAT and GRIP!

Recommended retail price
Delivery/assembly excluded
All previous lists are no longer
valid.

Development and design
Kettmaker-Team
All models and names registered.
All rights by Wolfgang Kettmaker.
Kettmaker reserves the right to make subsequent
changes, in particular if they serve the progress
or mean an improvement.
Errors excepted.
Date 30.05.2025

Kettmaker GmbH & Co. KG
Manufaktur für Möbel
Bussenstraße 30
88525 Dürmentingen
Deutschland