

PRODUCT INFORMATION 08-2023

ALEA

SLEEPING

Kettner

WARDROBE WITH FRONT

carcase modules
 W: 40 / 50 / 60 / 70 / 80 / 100 / 120
 H: 195 / 214 / 233 / 243 / 253 / 272
 total depth incl. front: 66
 Effective depth: Shelf 54 / clothes bar 60

Dimensions in cm

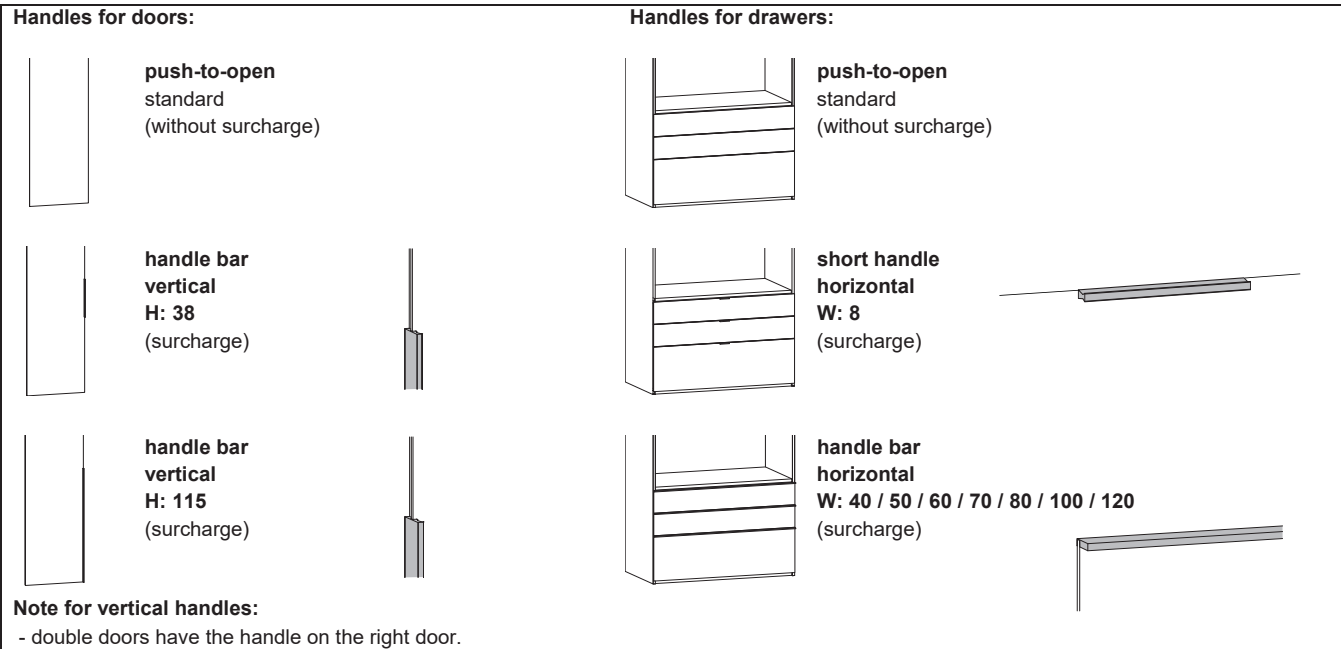
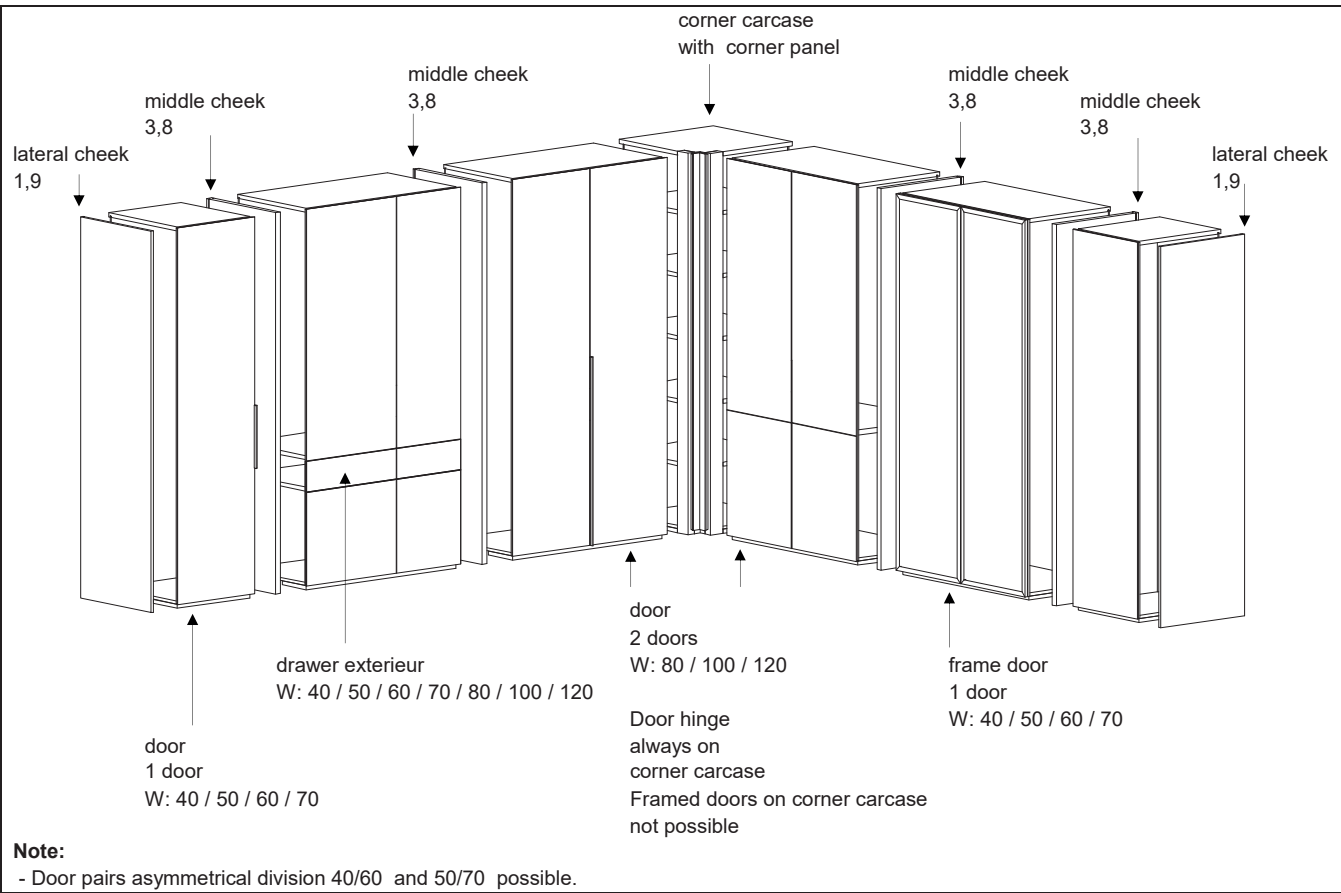

PLANNING INFORMATION:

- Required height for installation of wardrobe is carcase height + min. 3,0 cm.
- Required width: + 4,0 cm.
- Raster drilling in standard 9,6 cm, optional 3,2 cm possible.
- Shortening in W/D/H possible! See special requests.

WARDROBE WITH ASYMMETRIC FRONT DIVISION

possible for carcass modules:
 W: 100 / 120
 H: 195 / 214 / 233 / 243 / 253 / 272

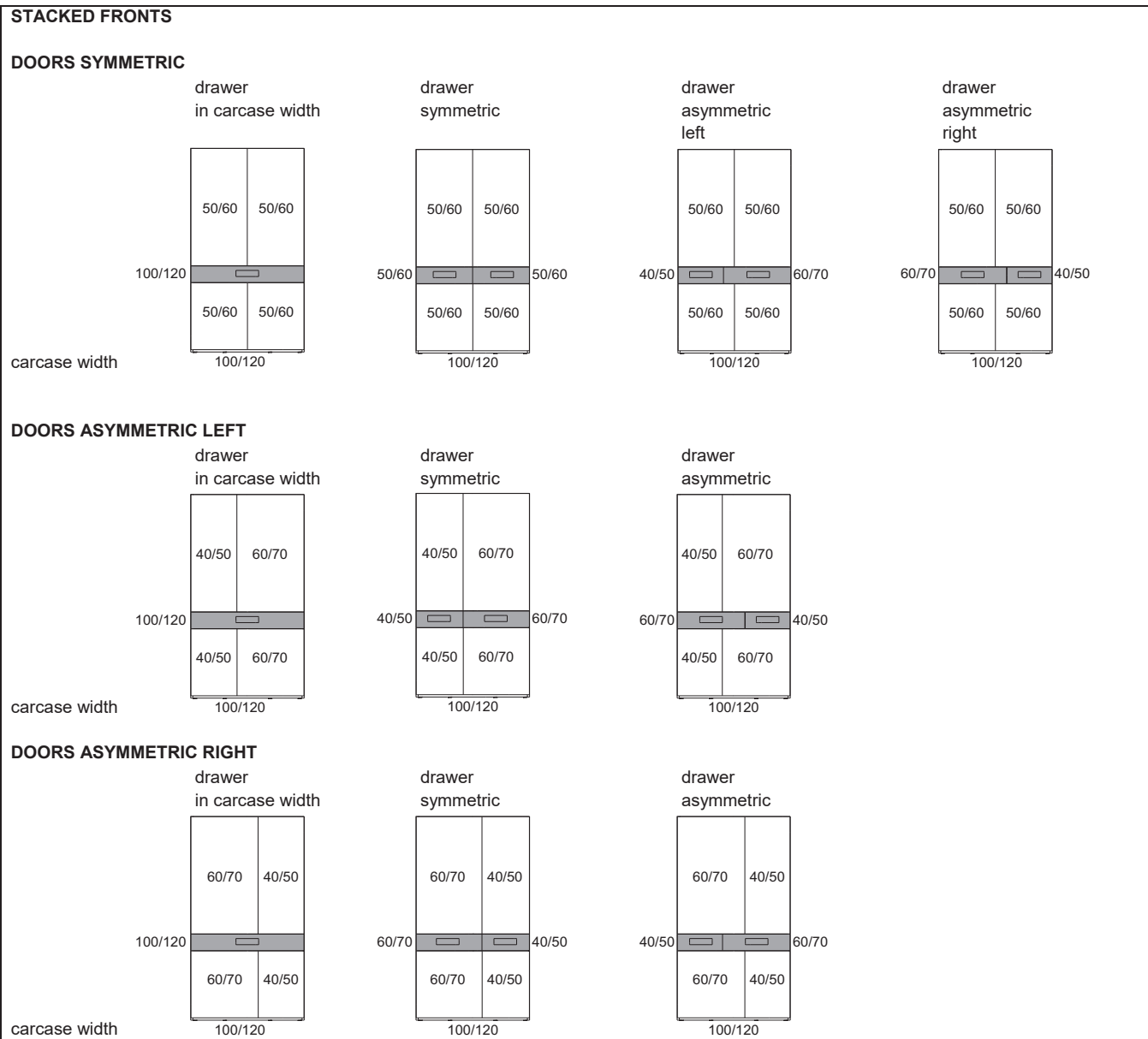
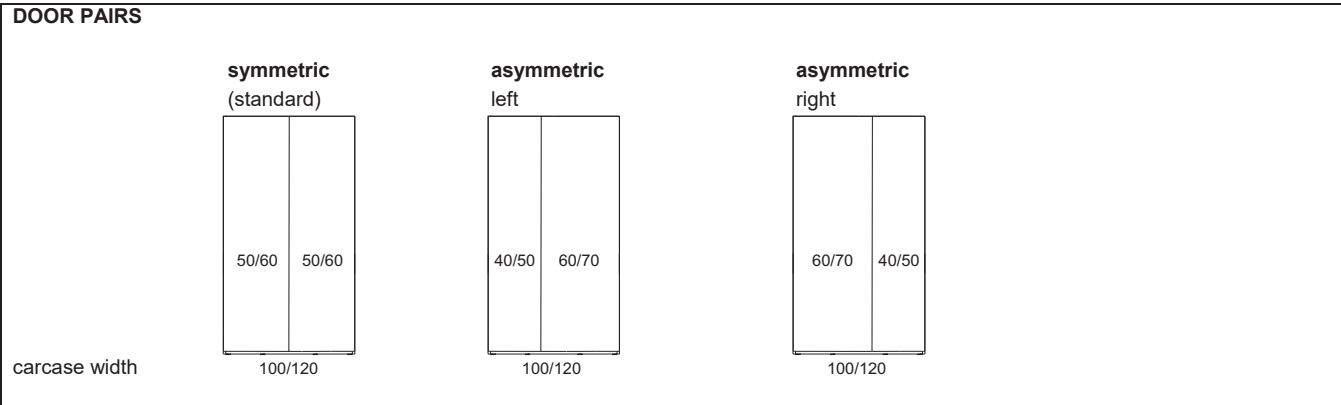

PLANNING INFORMATION:

- asymmetric front division for doors and drawers - without surcharge!

STACKED FRONTS:

- intermediary shelf between stacked fronts for constructive reasons.
- middle cheek between two drawers for constructive reasons.

WALK-IN WARDROBE COMBINED WITH FRONTS

carcase modules
 W: 40 / 50 / 60 / 70 / 80 / 100 / 120
 H: 195 / 214 / 233 / 243 / 253 / 272

Dimensions in cm

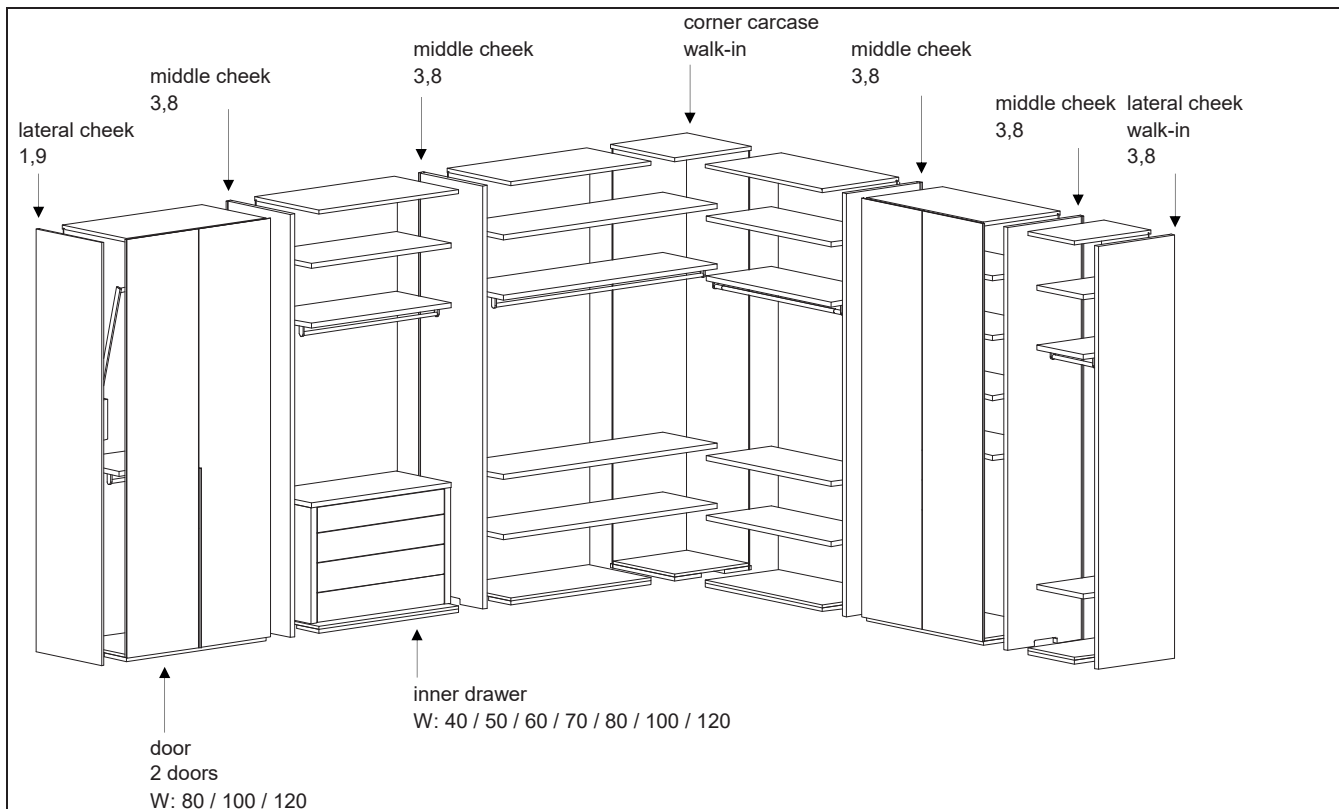

DETAIL CONSTRUCTION SHELF LEFT/RIGHT IN CORNER CARCASE- WALK-IN

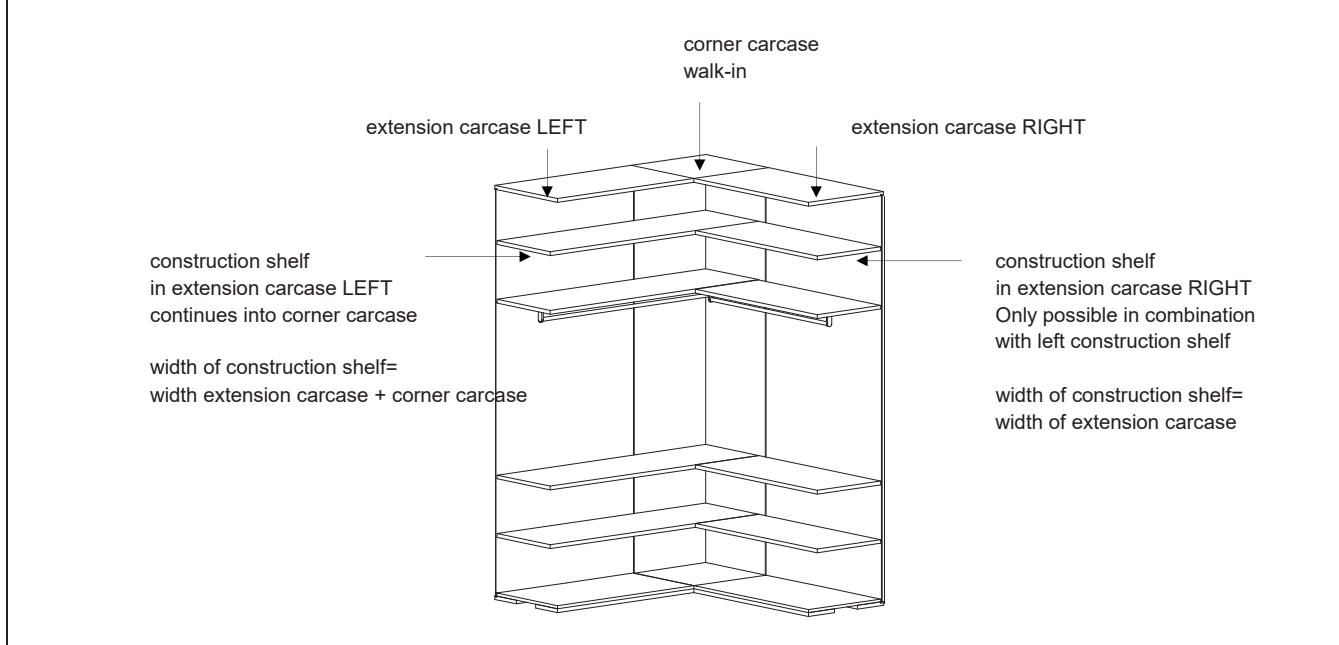

PLANNING INFORMATION:

- Required height for installation of wardrobe is carcase height + min. 3,0 cm.
- Required width: + 4,0 cm.
- Raster drilling in standard 9,6 cm, optional 3,2 cm possible.

INTERIOR FOR WARDROBE

W: 40 / 50 / 60 / 70 / 75 / 80 / 90 / 100 / 120

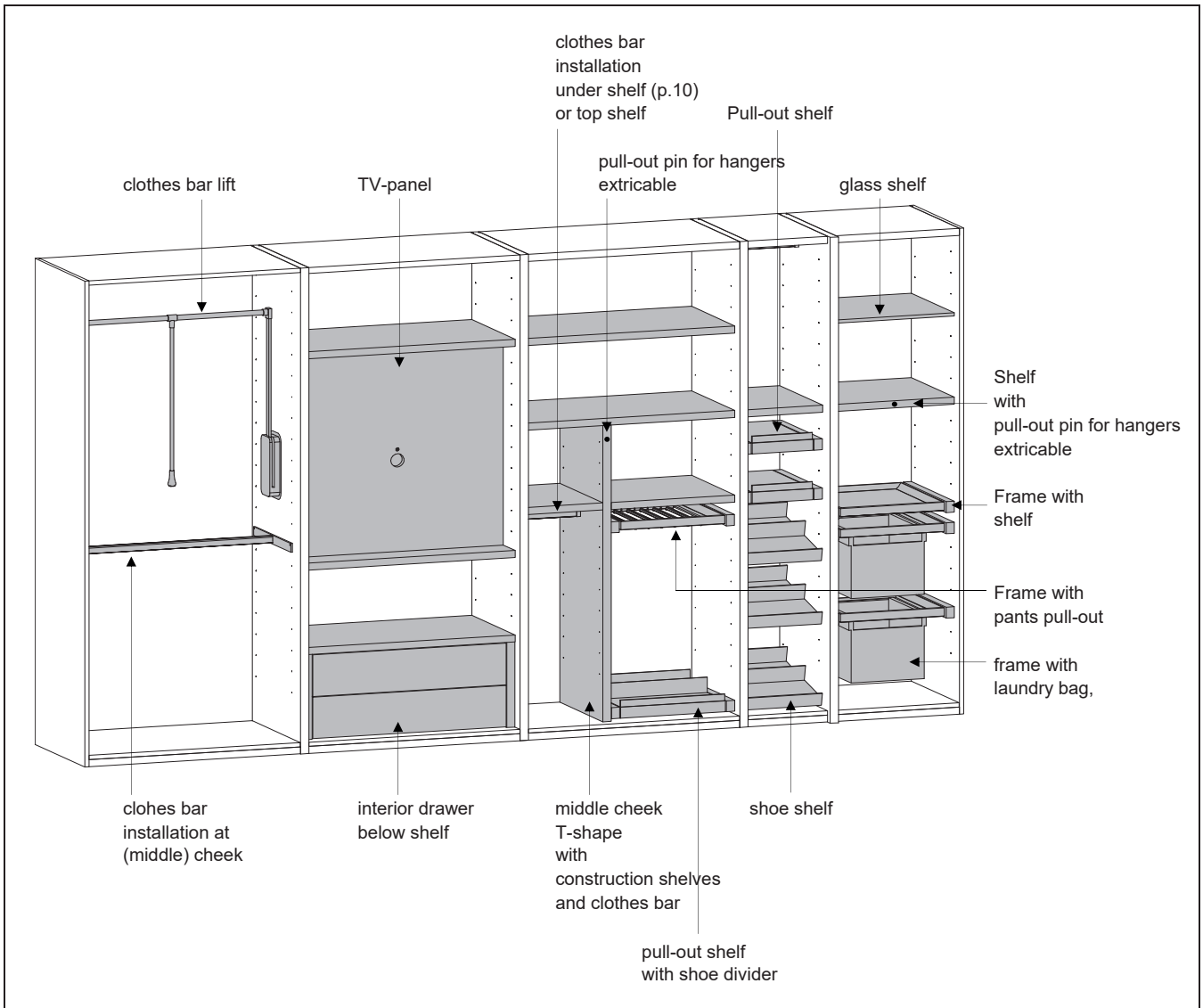

PLANNING INFORMATION:

- Interior partitions in widths 75 and 90 ONLY for FLAT and GRIP!

Development and design
Kettmaker-Team
All models and names registered.
All rights by Wolfgang Kettmaker.
Kettmaker reserves the right to make
subsequent changes, in particular if they
serve the progress or mean an improvement.
Errors excepted.
Date 31.05.2023

Kettmaker GmbH & Co. KG
Manufaktur für Möbel
Bussenstraße 30
88525 Dürmentingen
Deutschland

Tel. +49 (0) 7371 95 93-0
Fax +49 (0) 7371 95 93-20
www.kettmaker.com
info@kettmaker.com